

Notes:

- Electrical and elevator shut off in elevator room
- Riser undr stairs access in Rm 106
- HVAC on roof

1. Occ. Name: **Gresham Urgent Care**
 2. Address: **2850 E Powell Blvd**
 3. Occ Type: **Medical Facility**
 4. Cross St: **Hwy 26**



Powell Blvd

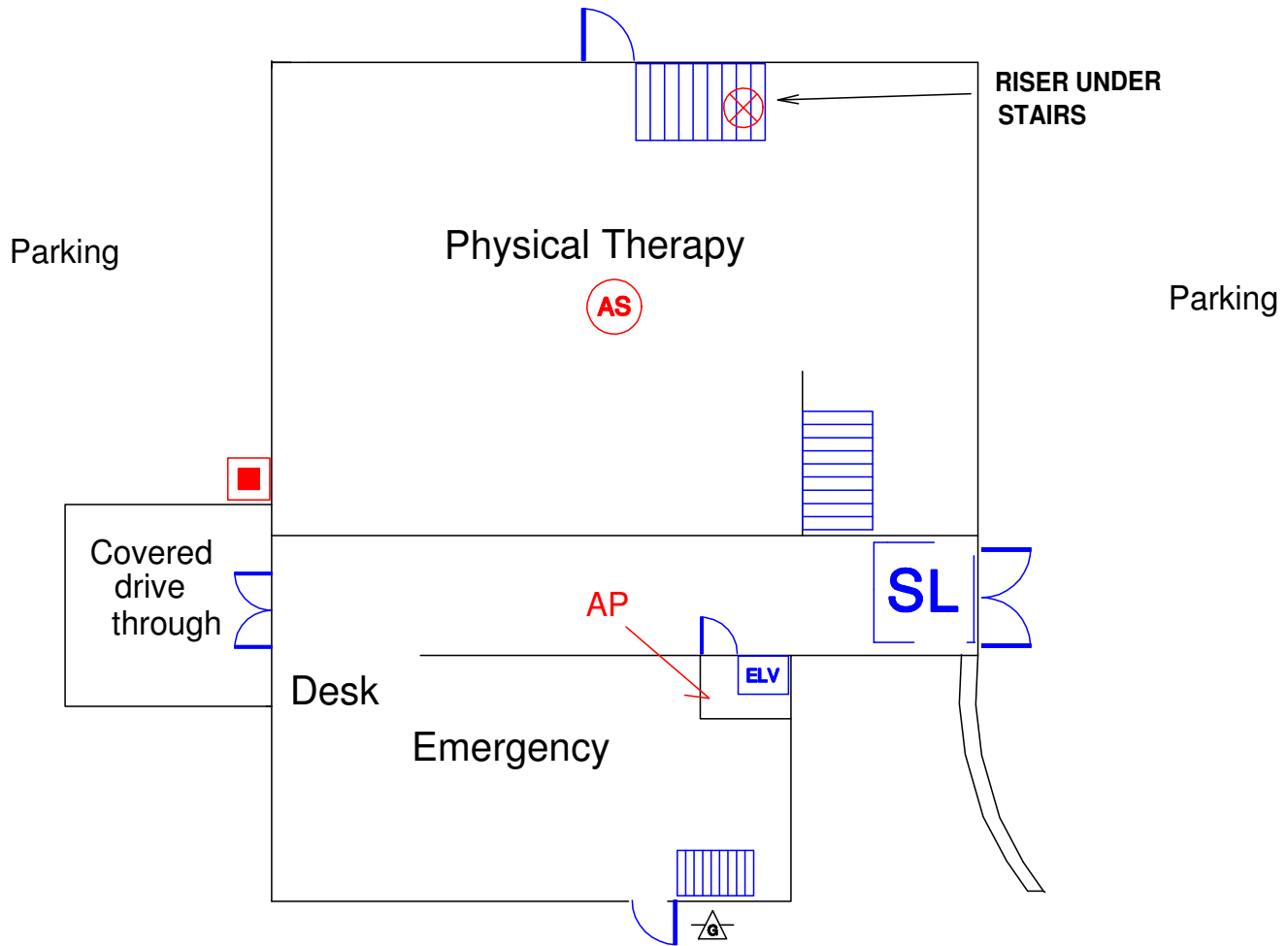

Stories: 2
Bldg Height: 20 ft
Bldg Area: 80 x 130 = 10400

Bldg Construction:
Wood Frame

Roof Construction: Light Weight Truss