

1. Occ. Name: Tri-Met Parking Structure
 2. Address: 523-575 NE 8th Street
 3. Occ Type: Reinforced Concrete
 4. Cross St: Kelly 8. Map # K-29

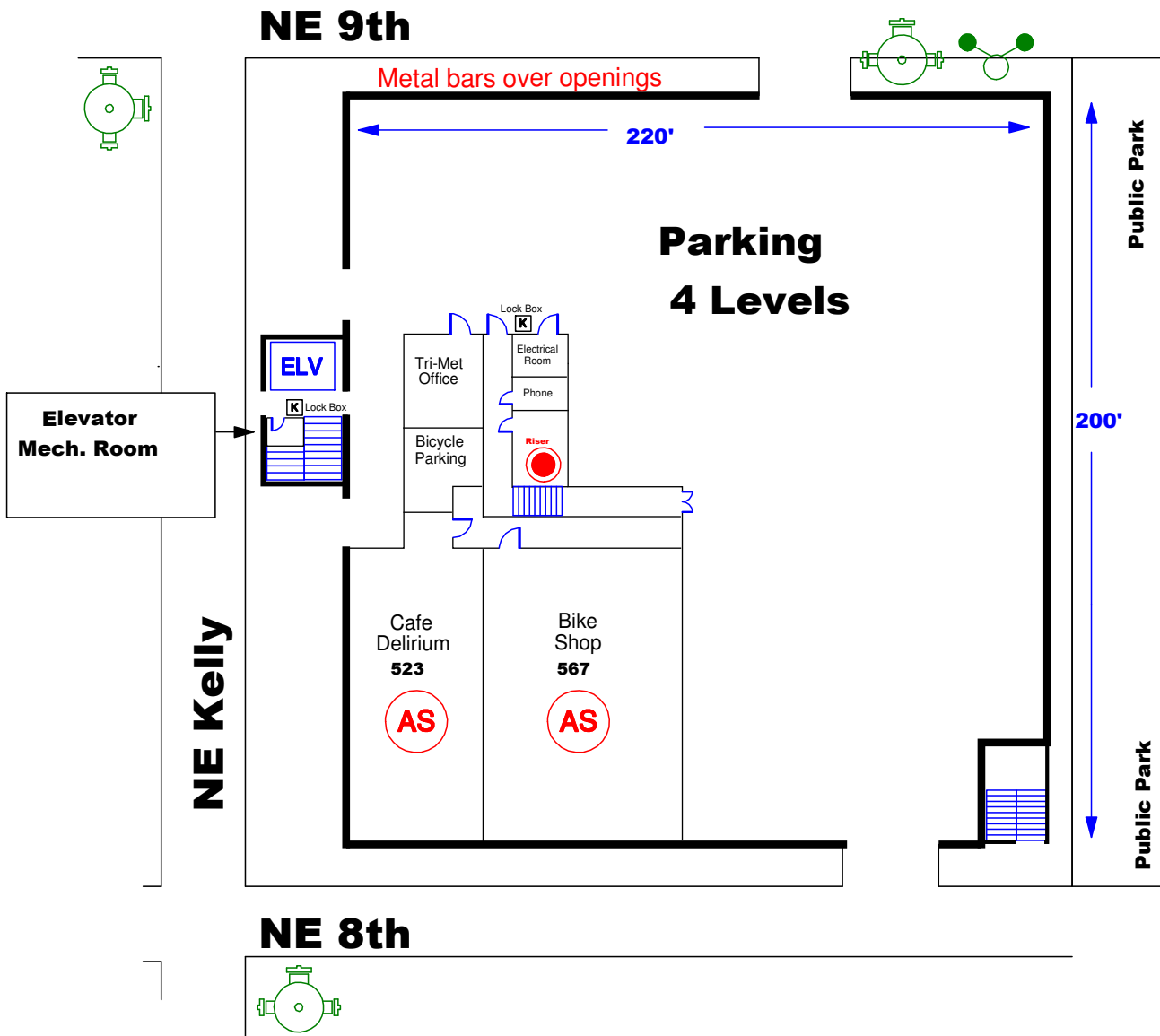

Construction Information:		Floors	Contact Number:
Type:	Non Combustible	4	
Lth:	200'	Wth: 220'	Special Information: Standpipe with 2 1/2" Connections Vehicle Clearance 7'2"
SqFt.	176,000	Flow 100% 58K GPM	
Roof:	Poured Reinforced Concrete Parking on Roof Level		Metal Security Bars on 1st Floor