

3007

~~3007~~

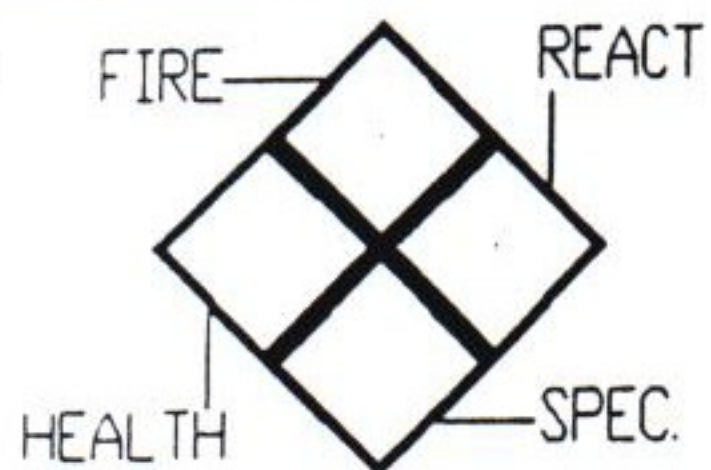

1. Occ. Name: X LYNCHWOOD SCHOOL
 2. Address: X 3615 SE 174TH ST
 3. Occ. Type: X (213) ELEMENTARY SCHOOL
 4. Cross St.: X 174TH & SE MARIE



6. Pg X 1 of X 1

8. Map #: X K25

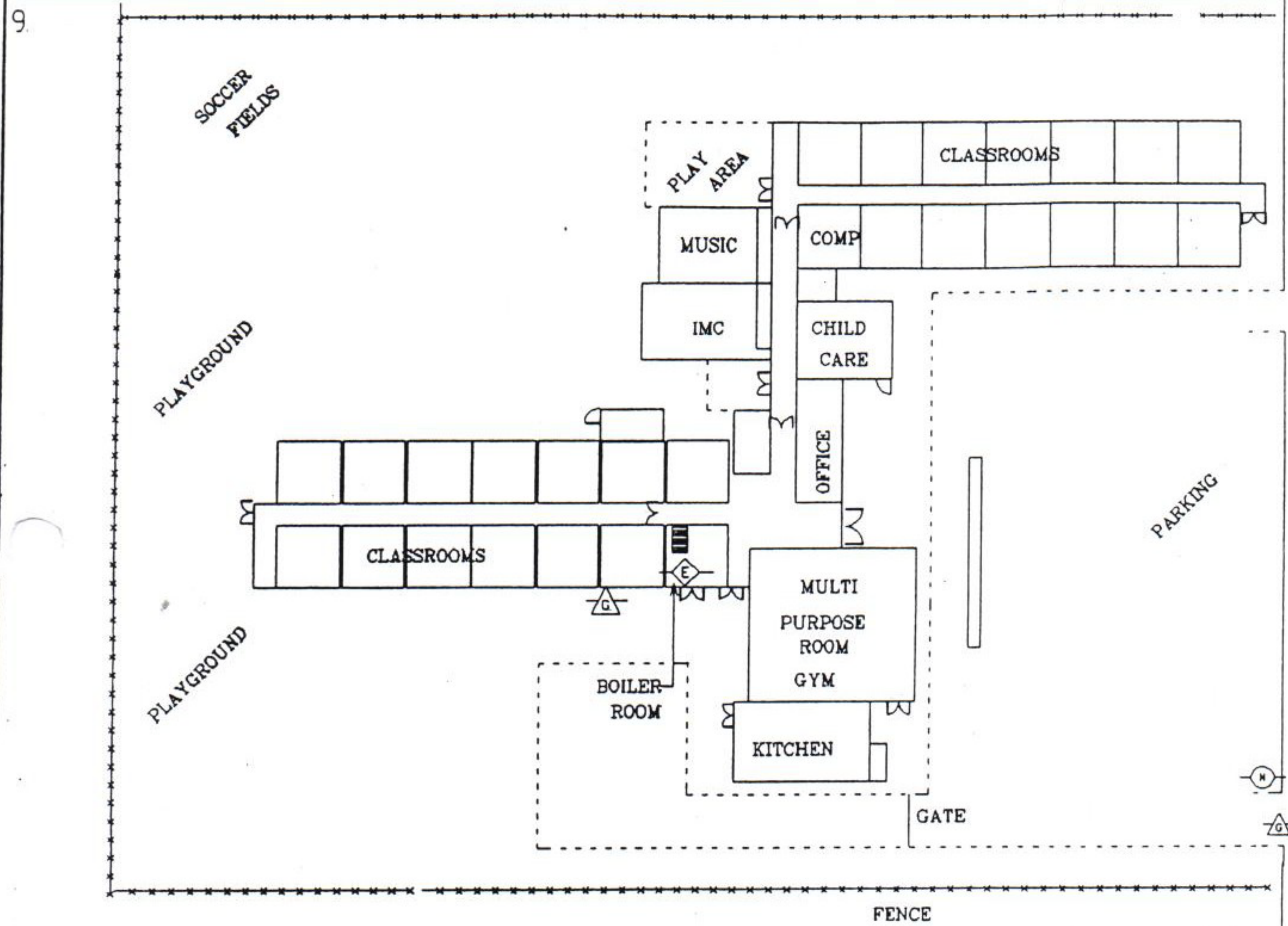

1. UTILITY TUNNEL RUNS PARALLEL WITH HALLWAYS, ACCESS E. SIDE OF BOILER ROOM.
2. HYDRANT N. IS APPROX. 600', HYD. S IS APPROX. 200'.
3. FIRE DOORS ARE 1 1/2 HR WOODEN IN HALLWAYS.
4. MAIN ELECT. PANEL IN BOILER ROOM.
5. ALARM PANEL IN OFFICE AREA.
6. NO LOCK BOX 5-9-94

10. Sprinkler: FDC Location
 NONE
 11. Haz. Materials:
 GENERAL HOUSEHOLD

12. Best Access:
 174TH VIA POWELL OR DIVISION ST

14. Bldg. Ht. X 18' Stories X 1 Ft. 15. Bldg Area: X 300' Ft. x X 285' Ft. 51,354 SQ FT

16. Roof Construction: Light Weight Truss _____ Unprotected Steel _____
 Heavy Truss ✓ ✓ Heavy Timber _____ Protected Steel _____ Concrete _____