

1. Occ. Name: WILKES SCHOOL

7.

2. Address: 17020 NE WILKES



3. Occ Type: PUBLIC SCHOOL

6. Pg 1 of 1

4. Cross St: 169TH/ SACRAMENTO

8. Map # H-25

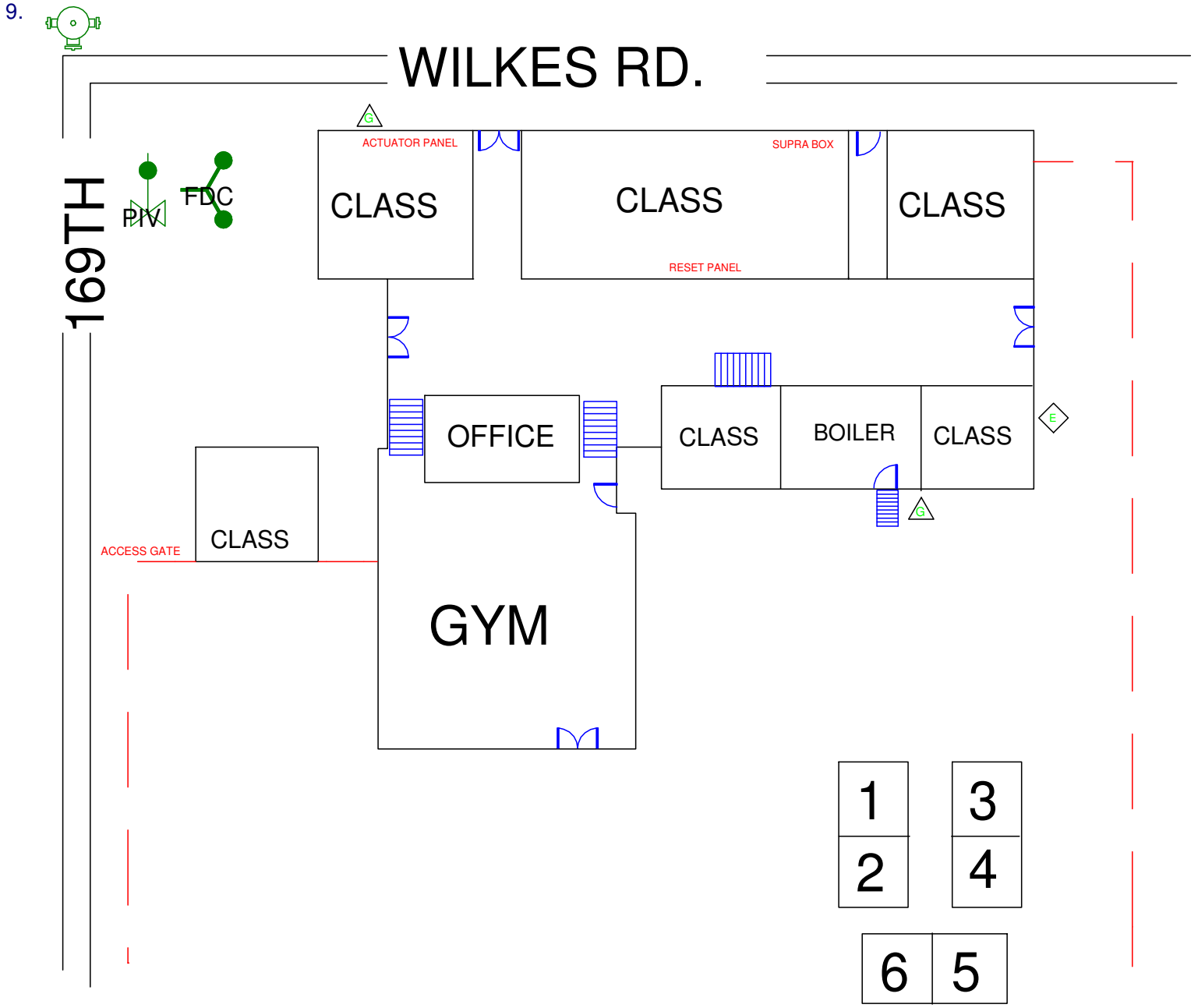

10. Sprinkler: FDC Location

11. Haz Materials

12. Standpipe: FDC Location

13. Best Access

HALLEY TO 169TH THEN NORTH

14. Bldg Ht. 30 Stories SPLIT LEVEL

15. Bldg Area 37,000 Ft. 375' × 110' Ft.

16. Roof Construction Light Heavy Truss  
Heavy Truss \_\_\_\_\_ Heavy Timber \_\_\_\_\_

Unprotected Steel \_\_\_\_\_  
Protected Steel \_\_\_\_\_ Concrete \_\_\_\_\_