

4/00

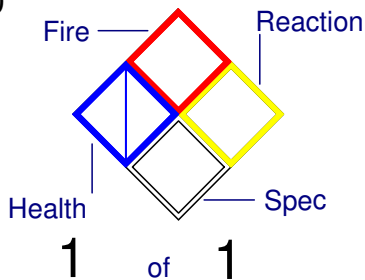

1. Occ. Name: NADIA APTS.
 2. Address: 17641-17687 SE DIVISION
 3. Occ Type: 423 (7-20 APT. UNITS)
 4. Cross St: 178 & DIVISION 8. Map # K25

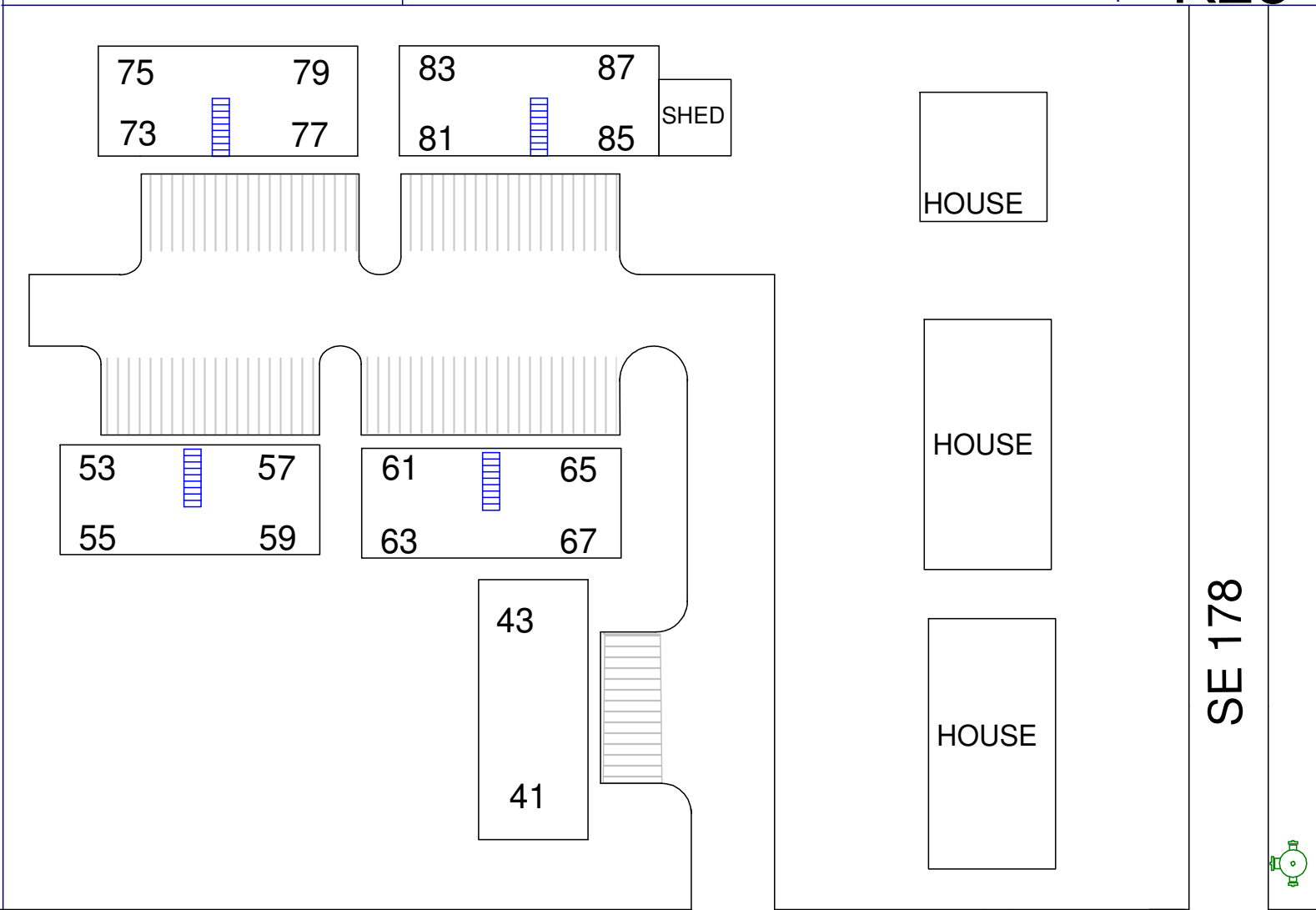

SE 176 SE DIVISION STREET SE 178
FIRE FLOW=1475 gpm

10. Sprinkler: FDC Location X None X	11. Haz Materials X Garden Chems. in Shed X
12. Standpipe: FDC Location X None X	13. Best Access X SE Division X
14. Bldg Ht. 25' Stories 2 Ft.	15. Bldg Area 4400 Ft. 55' × Ft. 40'
16. Roof Construction Light Heavy Truss <input checked="" type="checkbox"/> Heavy Truss _____ Heavy Timber _____	Unprotected Steel _____ Protected Steel _____ Concrete _____