

Special Notes

Occ. Name: KORAH MARIE APARTMENTS

Address: 17400 E. BURNSIDE ST.

Occ Type: APARTMENTS

Cross St: S.E. 172ND AV. Map # 5303D



Page 1 of 1

MAX

E.B. E. BURNSIDE ST.

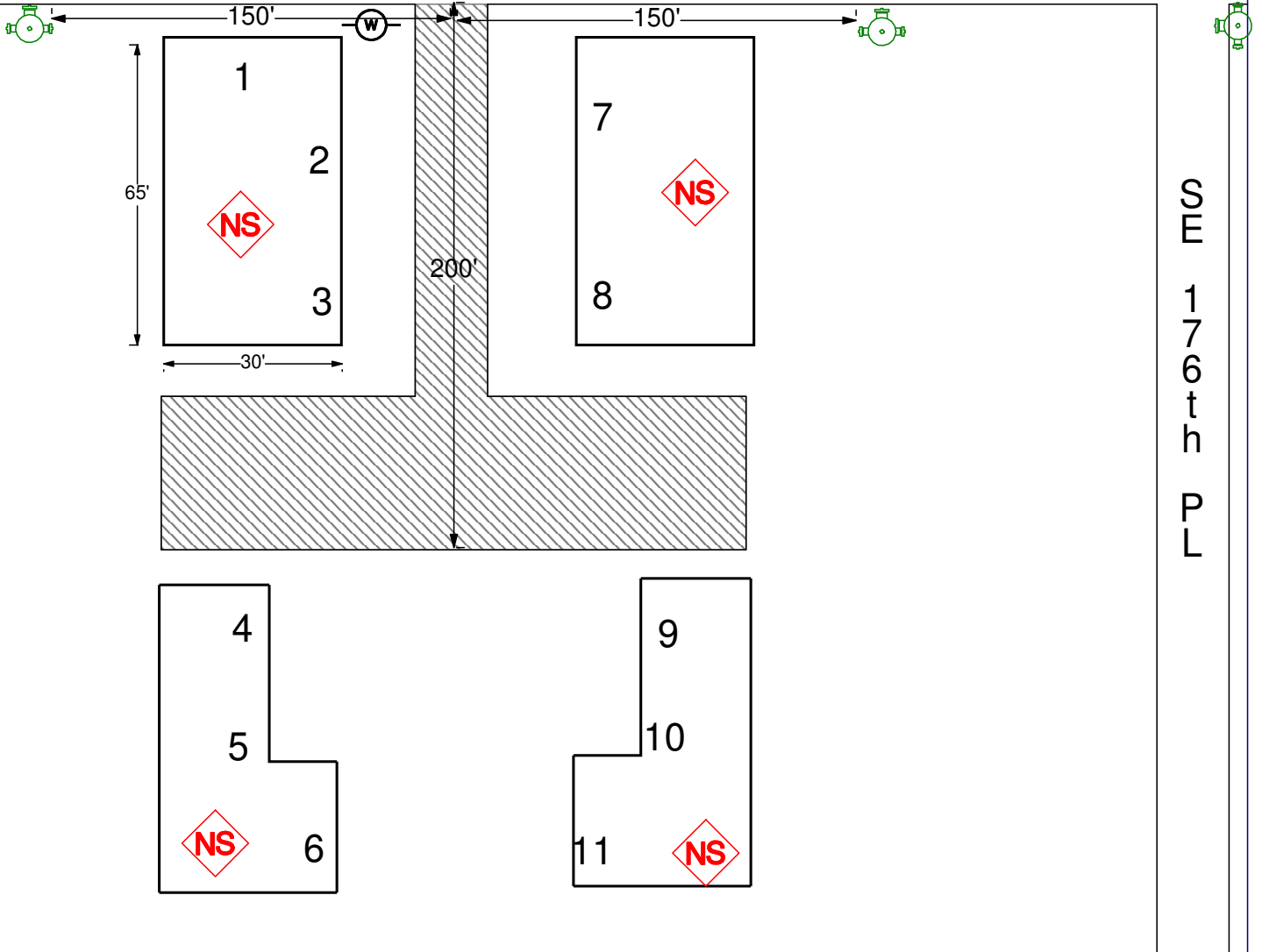

L X W 65 x 30

Stories or Height: 1 STORY

Total Bldg Area: 2,000 sq. ft.

Sprinkler: FDC Location
NONE

Riser:
NONE

NS

Roof Construction
WOODFRAME, PITCHED COMP.

Building Construction
LIGHTWEIGHT WOODFRAME