

2-98

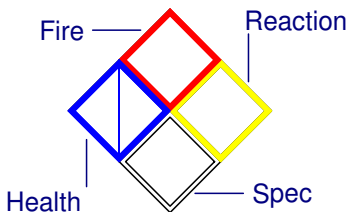

1. Occ. Name: **EXECUTIVE 181**

7.

2. Address: **1801 N.E. 162nd AVENUE**



3. Occ Type: **APARTMENTS**

6. Pg 1 of 1

4. Cross St: **N.E. HALSEY STREET**

8. Map # **I-24**

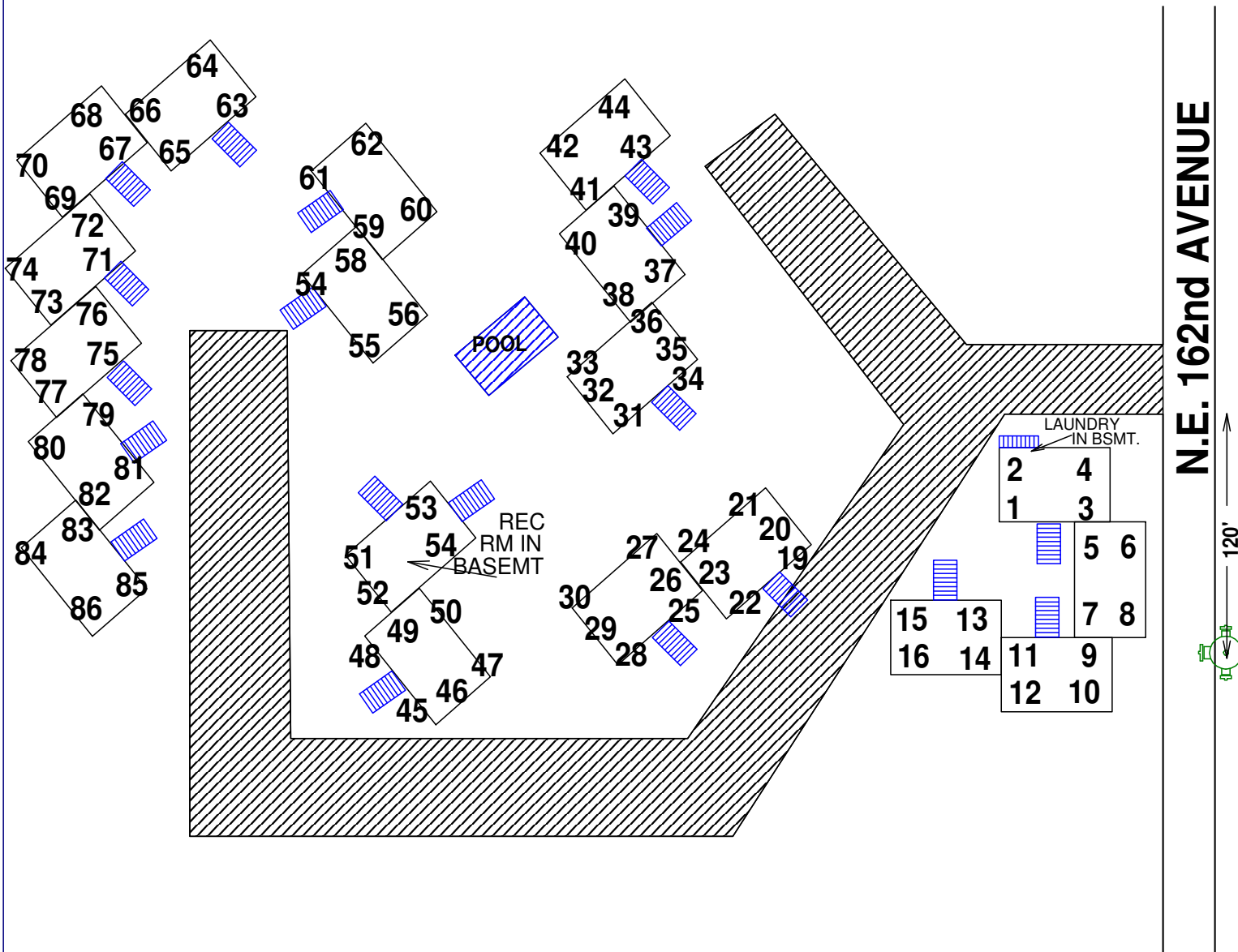

**N.E. HALSEY STREET**

10. Sprinkler: FDC Location  
**NONE**

11. Haz Materials  
**POOL CHEMICALS IN REC. ROOM**

12. Standpipe: FDC Location  
**NONE**

13. Best Access  
**N.E. 162nd AVENUE**

14. Bldg Ht. 20 - 30' Stories 2-1/2 Ft. 15. Bldg Area x Ft. x x Ft.

16. Roof Construction Light Heavy Truss XX Unprotected Steel \_\_\_\_\_  
Heavy Truss \_\_\_\_\_ Heavy Timber \_\_\_\_\_ Protected Steel \_\_\_\_\_ Concrete \_\_\_\_\_

4044