

6. Pg 1 of 1

1. Occ. Name: GLEN EAST APARTMENTS
 2. Address: 16431 N.E. GLISAN STREET
 3. Occ Type: APARTMENTS
 4. Cross St: N.E. 165th AVENUE
 7. _____
 8. Map # I-24

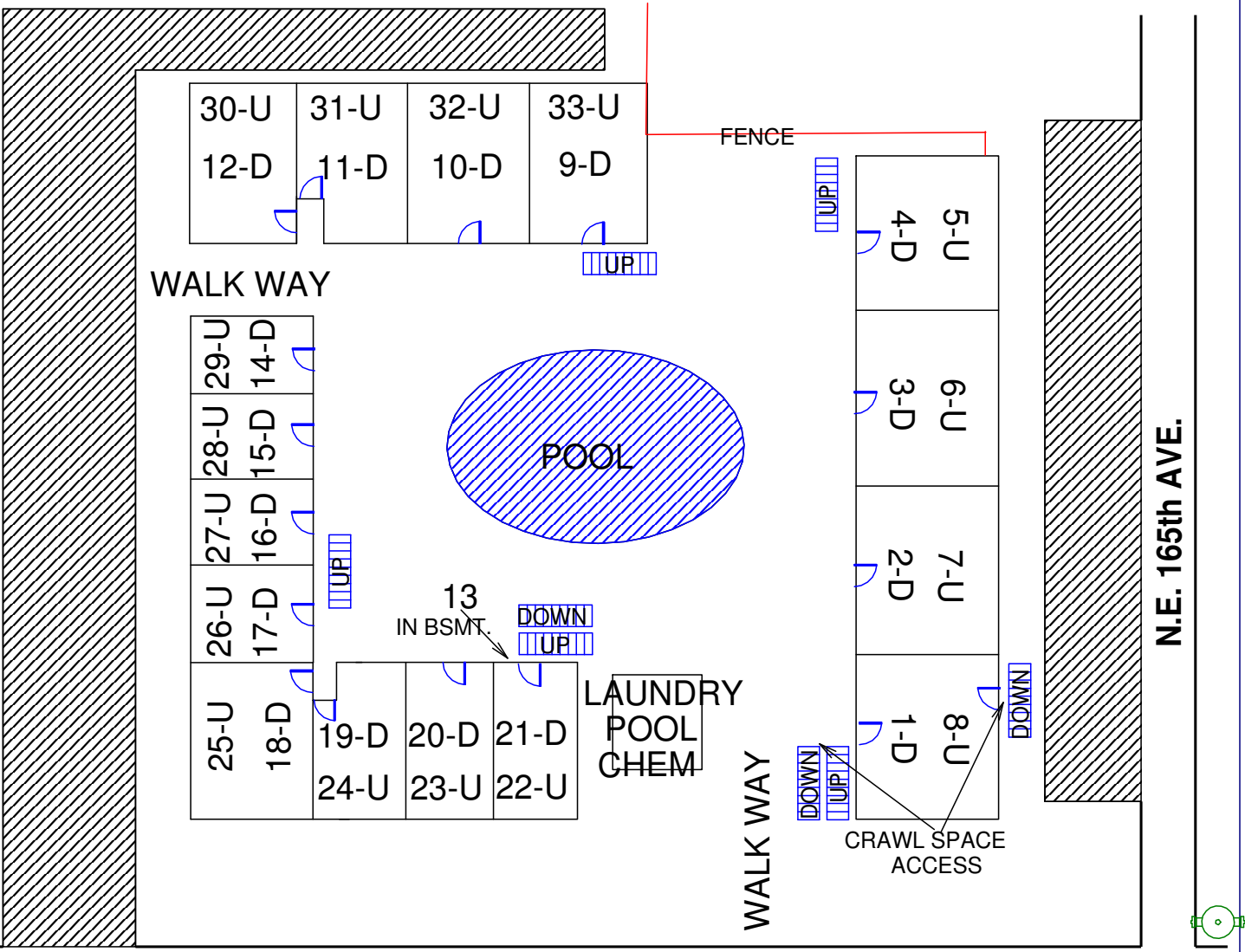

10. Sprinkler: FDC Location
 NONE

11. Haz Materials
 POOL CHEMICALS
 IN LAUNDRY BUILDING

12. Standpipe: FDC Location
 NONE

13. Best Access
 WEST DRIVEWAY

14. Bldg Ht.	Stories	Ft.	15. Bldg Area	Ft.	×	Ft.
16. Roof Construction	Light Heavy Truss	_____	Unprotected Steel	_____		
	Heavy Truss	_____	Protected Steel	_____		
	Heavy Timber	_____	Concrete	_____		